

# Incandescent Lamps

<b>Bulb Identification</b> .....	1-2	100/200/300 Watts .....	1-13
<b>Filament Identification</b> .....	1-2	110 Watts.....	1-13
<b>Base Identification</b> .....	1-2	116 Watts.....	1-13
<b>Lamp Locator</b> .....	1-3	120 Watts.....	1-13
<b>Introduction</b> .....	1-4	135 Watts.....	1-13
<b>Incandescent Brand Name Cross-Reference</b> .....	1-4	150 Watts.....	1-13
<b>GE Reveal® Light Bulbs</b> .....	1-5	175 Watts.....	1-13
<b>GE Long Life Floodlight or Spotlight</b> .....	1-5	200 Watts.....	1-13
<b>GE Rough Service A-Line Bulbs</b> .....	1-5	250 Watts.....	1-14
<b>Section Headings</b> .....	1-6	300-1000 Watts .....	1-14
<b>Incandescent Lamps</b>		<b>Export-Only</b>	
3-10 Watts .....	1-7	75 Watts.....	1-14
11 Watts.....	1-7	85 Watts.....	1-14
12-13.5 Watts.....	1-7	120 Watts.....	1-15
15 Watts.....	1-8	150 Watts.....	1-15
15/135/150 Watts.....	1-8	<b>Lumen Rated Traffic Signal</b>	
18 Watts.....	1-8	165 Watts.....	1-15
20 Watts.....	1-8	<b>Airport</b>	
25 Watts.....	1-8	30 Watts.....	1-15
27 Watts.....	1-9	40 Watts.....	1-15
30 Watts.....	1-9	200 Watts.....	1-15
30/70/100 Watts.....	1-9	620 Watts.....	1-15
34 Watts.....	1-9	1200 Watts .....	1-15
38 Watts (Complies with California Title 20 Regulations) .....	1-9	<b>Multiple Street Lighting</b>	
40 Watts.....	1-9	30 Watts.....	1-15
45 Watts.....	1-10	<b>Landscape Lighting</b>	
50 Watts.....	1-10	4 Watts .....	1-15
50/100/150 Watts.....	1-10	7 Watts .....	1-15
50/200/250 Watts.....	1-10	11 Watts.....	1-15
52 Watts.....	1-11	18 Watts.....	1-15
57 Watts (Complies with California Title 20 Regulations) .....	1-11	<b>Decorative</b>	
60 Watts.....	1-11	3 Watts .....	1-15
65 Watts.....	1-11	15 Watts.....	1-15
67 Watts.....	1-12	25 Watts.....	1-15
69 Watts.....	1-12	40 Watts.....	1-16
71 Watts (Complies with California Title 20 Regulations) .....	1-12	60 Watts.....	1-17
75 Watts.....	1-12	75 Watts.....	1-17
85 Watts.....	1-12	100 Watts.....	1-17
90 Watts.....	1-13	150 Watts.....	1-17
95 Watts (Complies with California Title 20 Regulations) .....	1-13	<b>Portable Lighting Products</b> .....	1-17
100 Watts.....	1-13	<b>Warning and Caution Notices</b> .....	1-18
		<b>Cross-Reference</b> .....	1-19

Halogen

High Intensity  
Discharge

Fluorescent

Compact  
Fluorescent

Ballast

LED Lamps  
and Systems

Stage and Studio

Miniature and  
Sealed Beam

Projection

# Incandescent Lamps

## Bulb Identification

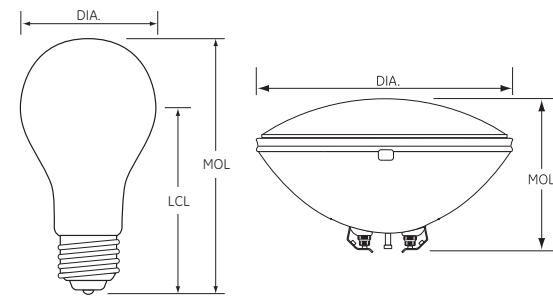

DIA: Diameter of bulb at widest point.  
 MOL: Maximum Overall Length including base or pins.  
 LCL: Distance between the center of the arc tube and the Light Center Length reference plane.  
 Note: Lamp drawings are not drawn to scale. Be sure to check size and dimension information when identifying each lamp.  
 To convert inches to millimeters, multiply the dimension (in inches) by 25.4 (i.e. 1.5" x 25.4 = 38.1 mm).

## Filament Identification

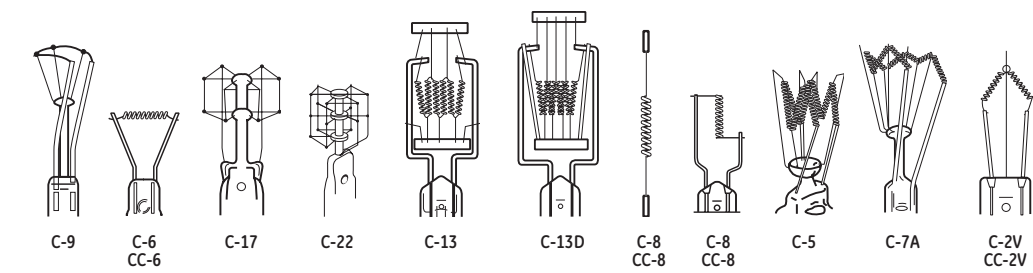

## Base Identification

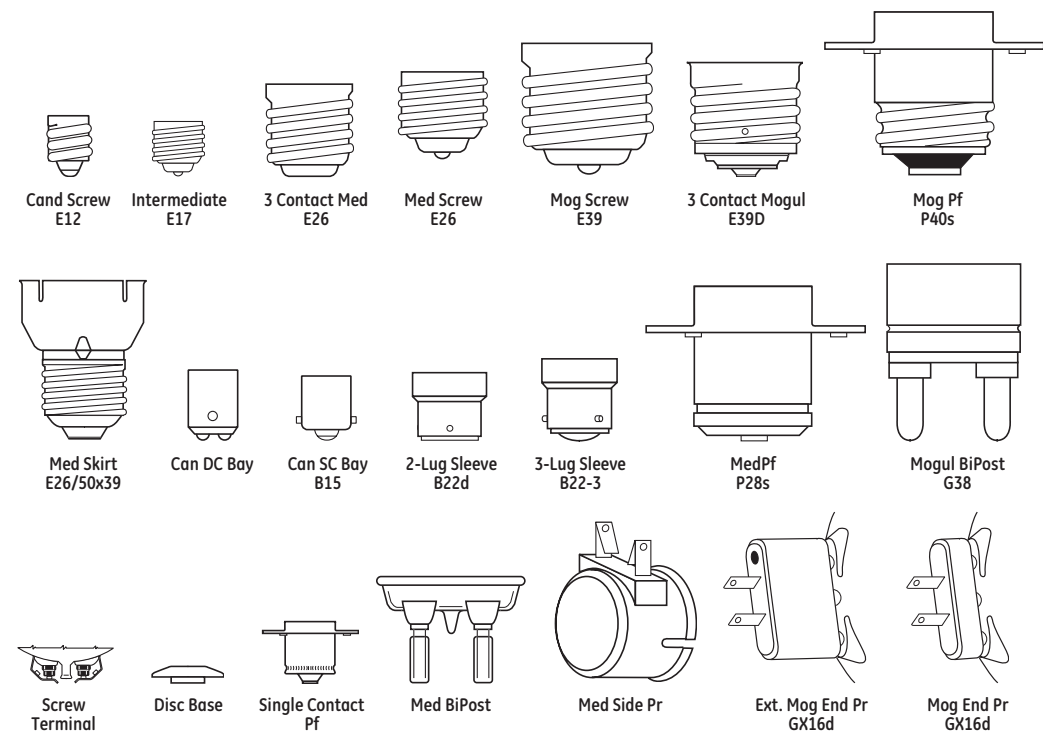

## Lamp Locator

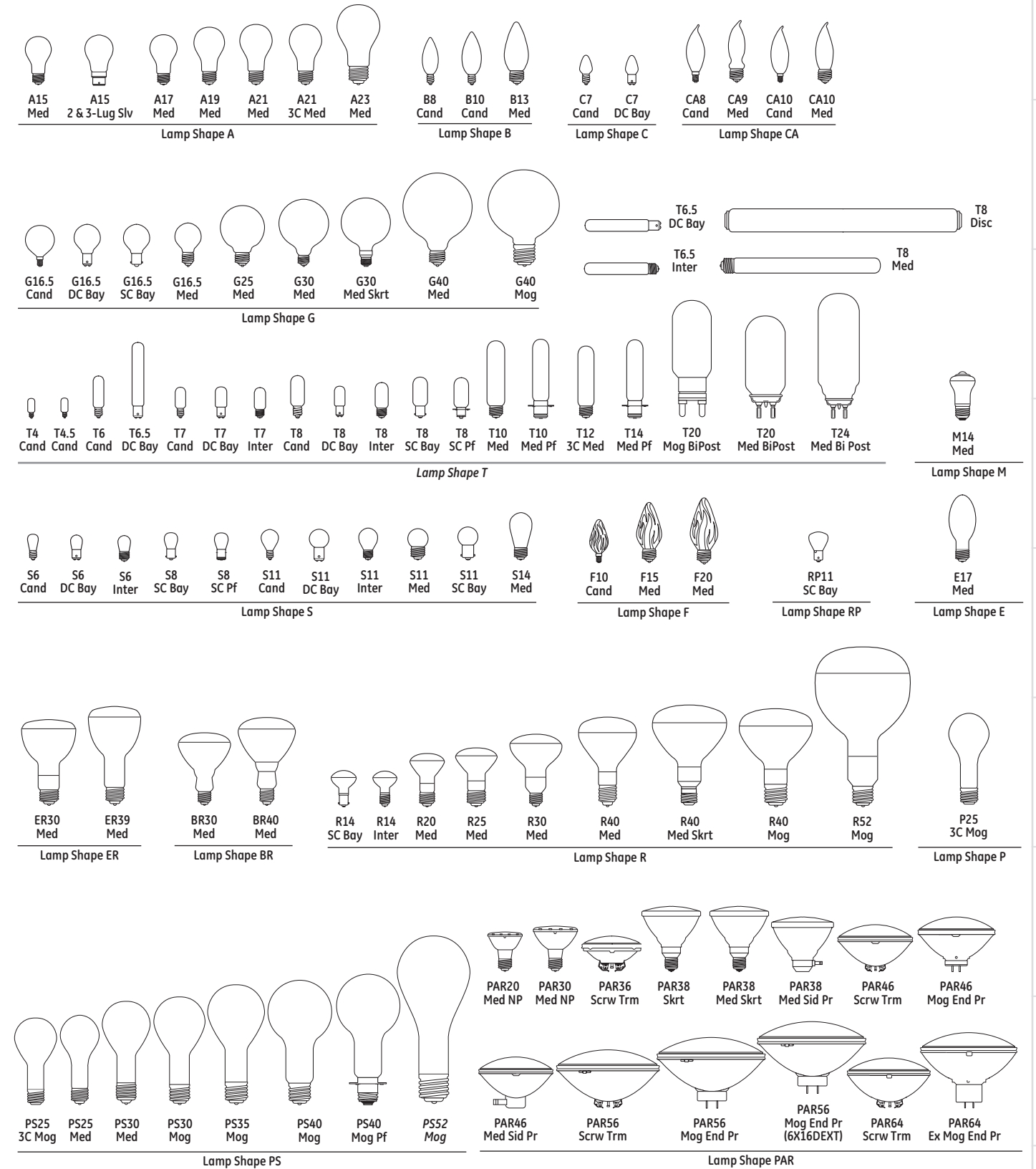

# Incandescent Lamps

## Introduction

GE's incandescent lamps trace their ancestry to the world's first practical electric bulb, invented by Thomas Alva Edison, founder in 1879 of the company that became General Electric Company.

More than a century of research and development later, the present range of GE incandescent lamps represents the state of the art of lamps for residential and commercial use, as well as special purpose lamps for decorative or display applications.

In an incandescent lamp, light is generated by heating the filament to incandescence. The hotter the filament, the more efficient it is in converting electricity to light. However, when the filament operates hotter, its life is shortened so the design of each lamp is a balance between efficiency and life. This is why lamps of equal wattage may have different lumen ratings and different life ratings.

Incandescent lamps of similar size are commonly available with different wattage ratings. The fixture wattage limit should not be exceeded.

### Protection From Moisture

When Hard Glass appears in the Additional Information column, the outer bulbs are made of special thermal-shock-resistant glass. Sometimes external protection of the lamps is also needed to eliminate the chance of bulb breakage due to contact with water during operation. Footnotes will indicate when external protection is needed. Where Hard Glass is not indicated, the bulb glass is such that the lamps require protection from exposure to mist or condensation as well as direct contact with water during operation.

### Rated Life

Values are based on a large number of representative lamps under controlled conditions. Individual lamps or groups of lamps may vary from the Rated Life shown. Rated Life is a median value of life expectancy – the total operating time at which under normal conditions 50% of any large group of initially installed lamps are expected to be still burning.

## Incandescent Brand Name Cross-Reference

GE	OSRAM/SYLVANIA	PHILIPS
Reveal®	—	—
Bug-Lite	Bug Lite	Bug-A-Way®
covRguard®	Safeline	Silicone Coated
Saf-T-Gard®	—	—
Soft Pink	Soft Pink	Softone Pastels
Plant Light	Spot-GRO	Agro-Lite
Long Life Soft White	Double Life™ Soft White	Longer Life Soft White
Party Light	—	—
Watt-Miser®	Super Saver®	Econ-o-Watt®
Watt-Miser® Plus	Super Saver Excel®	Extended Service

ATTENTION: This brand-name cross-reference chart is provided only as a quick reference. Other lamp company brand listings may only represent a near equivalent, versus an identical match to GE brands. Individual lamp manufacturers' product offerings and performance specifications should be consulted. Lamp performance may be affected by environmental conditions, and/or auxiliary equipment.

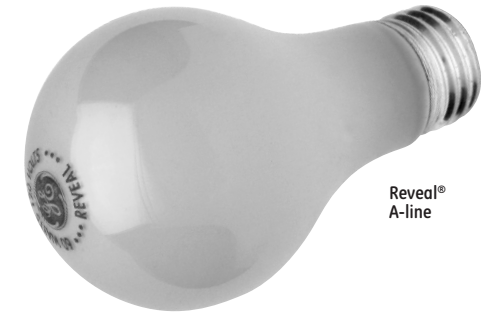

Reveal® A-line



Long Life BR30 Reflector Floodlight or Spotlight

### GE Reveal® Light Bulbs

Superior light quality over regular incandescent that:

- Produces "clean, beautiful light"® for more vibrant colors
- Contains Neodymium glass that filters out dulling yellow rays
- Is available in 40-150 watt A-Line
- Also available for nearly every application from candle shapes to flood lights
- A color-enhanced full-spectrum light bulb

### GE Rough Service A-Line Bulbs

Built to last, even under many "rough" service conditions...

- Extra filament support design protects against early burnouts caused by bumps, jars and vibration
- Longer life
- Dual Voltage Rating (120V/130V) provides application flexibility
- Saf-T-Gard® coating available – coating is shatter and weather-resistant; resists breakage from heat and thermal shock that can occur from water, sleet, snow, molten solder and weld spatter

### GE Long Life Floodlight or Spotlight

- 25% longer life than standard reflectors. Ideal for use in high ceilings and hard-to-reach track lighting
- Easy replacement – same length and width as standard R bulbs
- Some lumen loss from standard reflectors (see listing for lumen values)
- Available in 45W floodlight and 65W floodlight and spotlight

#### Uses:

- Down lighting, display lighting, accent lighting, wall washing
- Wherever standard reflector bulbs are used

# Incandescent Lamps

## Headings in this catalog section

The following terms and descriptions can help you when checking Incandescent lamp specifications and when ordering products.

Within this product line, lamps are divided by wattage. Within wattage, lamps are listed alphabetically by bulb shape.

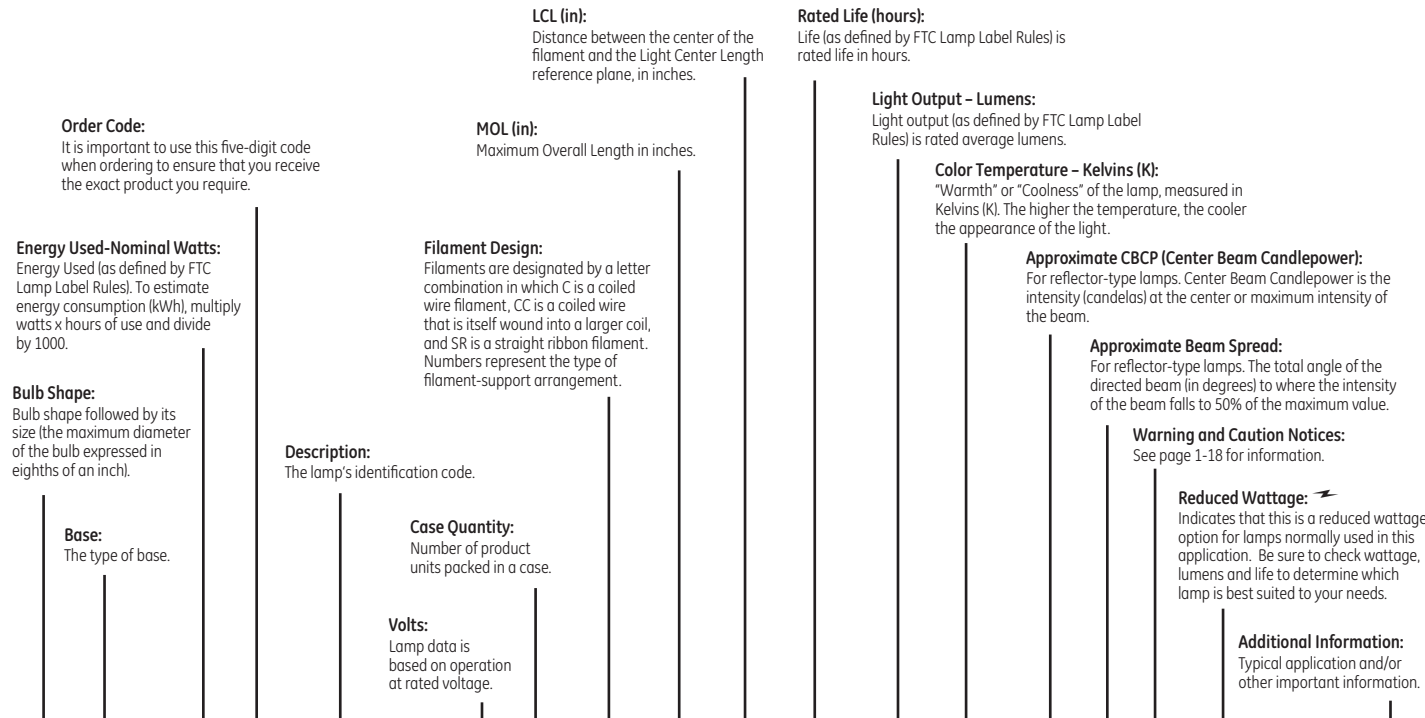

Bulb Shape	Base	Watts	Order Code	Description	Volts	Case Qty	Filament Design	MOL (in)	LCL (in)	Rated Life (hrs)	Lumens Initial	Color Temp K	CBCP	Beam Spread	Warning and Caution Notices	Reduced Wattage	Additional Information
<b>Incandescent Lamps</b>																	
<b>3 Watts</b>																	
S6	Cand	3	11098	75R30/FL/65WM/A	130	24	C-7A	1.87	1.37	3000	11						Clear-Indicator

**75 R30 / FL / 65WM / A**

- Identifies the lamp's wattage.
- Identifies the lamp's shape.
- Identifies the lamp as a floodlight.
- Identifies the lamp as a Watt-Miser®.
- Identifies this lamp as amber colored.

**WHEN YOU DON'T KNOW THE LAMP DESCRIPTION**

1. Identify the lamp wattage.
2. Measure bulb diameter using ruler in appendix section page A-1 to determine width in eighths of an inch.
3. Identify base type using table on page 1-2.
4. Find your lamp in the table containing the bulb wattage, then match the shape, size and base, which are all listed alphabetically.

Bulb Shape	Base	Watts	Order Code	Description	Volts	Case Qty	Filament Design	MOL (in)	LCL (in)	Rated Life (hrs)	Lumens Initial	Color Temp K	CBCP	Beam Spread	Warning and Caution Notices	Reduced Wattage	Additional Information			
<b>Incandescent Lamps</b>																				
<b>3 Watts</b>																				
S6	Cand	3	11098	356/5 24PK	130	24	C-7A	1.87	1.37	3000	11						Clear-Indicator			
<b>4 Watts</b>																				
C7	Cand	4	16001	4C7/W CD2	120	240	C-7A	2.12		3000					2e		White-Long Life Night Light			
		4	43050	4C7 CARD 2	120	240	C-7A	2.12		3000					2e		Long Life Clear Night Light			
		4	73257	4C7/S/CD4-6PK	120	6	C-7A	2.12		2000					2e		Standard-Clear Night Light			
		4	73258	4C7/S/W/CD4-6PK	120	6	C-7A	2.12		2000					2e		Standard-Clear Night Light			
		4	73259	4C7/PK/CD2-6PK	120	6	C-7A	2.12		3000					2e		Pink-Long Life Night Light			
4	73260	4C7/BL/CD2-6PK	120	6	C-7A	2.12		3000					2e			Blue-Long Life Night Light				
<b>6 Watts</b>																				
S6	Cand	6	11316	6S6 24PK	12	24	C-2V	1.87	1.37	1500	50							Clear-Indicator		
		6	11329	6S6	24	240	C-2V	1.87	1.37	1500	50							Clear-Indicator		
		6	11331	6S6 24PK	30	24	C-2V	1.87	1.37	1500	50							Clear-Train		
		6	43397	6S6 BB	32	24	C-2V	1.87	1.37	1500	50							Clear-Train		
		6	11367	6S6 TRAY	120	240	C-7A	1.87	1.37	1500	41							Clear-Indicator, 12-Lamp Tray		
		6	11577	6S6/3	120	240	C-7A	1.87	1.37	5000	23							Clear-Signal Light		
		6	15820	6S6 CARD2	120	240	C-7A	1.87	1.37	1500	41							Clear-Indicator		
		6	11369	6S6 TRAY	130	240	C-7A	1.87	1.37	1500	41								Clear-Indicator, 12-Lamp Tray	
		6	11372	6S6	145	240	C-7A	1.87	1.37	1500	41								Clear-Indicator	
		6	11374	6S6	155	240	C-7A	1.87	1.37	1500	41								Clear-Indicator	
		S6	DC Bay	6	11357	6S6DC 24PK	75	24	C-7A	1.81	1.43	1500	45							Clear-Indicator
				6	11592	6S6DC TRAY	120	240	C-7A	1.81	1.43	1500	41							Clear-Indicator, 12-Lamp Tray
				6	11594	6S6/DC TRAY	130	240	C-7A	1.81	1.43	1500	41							Clear-Indicator, 12-Lamp Tray
		S6	Inter	6	11660	6S6/7 TRAY 24PK	120	24	C-7A	1.81	1.06	1500	41							Clear-Indicator, 12-Lamp Tray
				6	11764	6T41/2/1	130	100	C-7A	1.87	1.31	1500	42							Clear-Indicator
<b>7 Watts</b>																				
C7	Cand	7	11779	7C7 TRAY	120	240	C-7A	2.12		3000	46							Clear-Indicator, 12-Lamp Tray		
		7	11815	7C7/W TRAY	120	240	C-7A	2.12		3000	36							White-Indicator, 12-Lamp Tray		
		7	11792	7C7 TRAY	130	240	C-7A	2.12		3000	46							Clear-Indicator, 12-Lamp Tray		
<b>7.5 Watts</b>																				
S11	Med	8	11847	7 1/2S TRAY	120	240	C-9	2.25		1400	53							Clear-12-Lamp Tray		
		8	73261	7 1/2S/CW/CD-5PK	120	5	C-9	2.25		1400	39				2e			White		
		8	11848	7 1/2S TRAY	130	240	C-9	2.25		1400	53							Clear-12-Lamp Tray		
		8	11922	7 1/2S/CW TRAY	130	240	C-9	2.25		1400	39							White-12-Lamp Tray		
<b>10 Watts</b>																				
S6	Cand	10	12041	10S6/10	230	24	C-7A	1.87	1.37	1500	66							Clear-Indicator		
		10	12050	10S6/10 24PK	250	24	C-7A	1.87	1.37	1500	66							Clear-Indicator		
S6	DC Bay	10	12060	10S6/10DC 24PK	230	24	C-7A	1.87	1.87	1500	66						Clear-Indicator			
S11	Cand	10	12249	10S11/79	120	120	C-7A	2.25	1.56	1000	80							Clear-Indicator		
		10	12188	10S11N/F	120	120	C-7A	2.31	1.62	1000	79							Frost-Appliance		
<b>11 Watts</b>																				
S14	Med	11	12575	11S14	130	120	C-9	3.50	2.50	3000	76							Clear-Sign		
		11	12589	11S14/IF	130	120	C-9	3.50	2.50	3000	76							I.F.-Sign		
		11	12621	11S14/R	130	120	C-9	3.50	2.50	3000								Red-Sign		
		11	12632	11S14/Y	130	120	C-9	3.50	2.50	3000								Yellow-Sign		
<b>12 - 13.5 Watts</b>																				
S8	SC Bay B15	12	10690	12S8/93T-CD2 6PK	12	240	C-2R	2.00	1.25	1000	200						2g	Low Voltage, High Intensity		
S11	SC Bay BA15s	14	12649	13/3 1/2 S11/95	10	120	CC-6/ C-12	2.37	1.25	1000	180							Clear-Railway Signal Light, Filament in Multiple		

Incandescent  
Halogen  
High Intensity Discharge  
Fluorescent  
Compact Fluorescent  
Ballast  
LED Lamps and Systems  
Stage and Studio  
Miniature and Sealed Beam  
Projection

# Incandescent Lamps

Bulb Shape	Base	Watts	Order Code	Description	Volts	Case Qty	Filament Design	MOL (in)	LCL (in)	Rated Life (hrs)	Lumens Initial	Color Temp K	CBCP	Beam Spread	Warning and Caution Notices	Reduced Wattage	Additional Information		
<b>Incandescent Lamps (continued)</b>																			
<b>15 Watts</b>																			
A15	Med	15	12784	15A	34	120	C-9	3.56	2.37	1000	180				5a		I.F.-Train		
		15	97491	15A/W-2PK	120	24	C-9	3.50	2.37	2500	110							Soft-White	
		15	12658	15A15	130	120	C-9	3.50	2.37	2500	115							Inside Frost	
		15	97488	15A15/CL-2PK	120	24	C-9	3.50	2.37	3000	110							Clear	
R14	SC Bay B15	15	33404	15R14SC/SP	12	120	CC-8	2.62		2000	120						Reflector Spot		
S11	Cand	15	13210	15S11/13	120	120	C-7A	2.25	1.56	750	115						Clear		
S11	DC Bay	15	13188	15S11/3DC	75	120	C-9	2.37	1.25	1000	138						Clear-Train		
S11	Med	15	13291	15S11/102	120	240	C-7A	2.25		400	120						Clear-Refrigerator, 12-Lamp Tray		
S14	Med	15	42590	15S14/FBB	34	120	C-9	3.50	2.50	1000	144						Frost-Locomotive Cab		
		15	11137	15S14/GR/CL/8	130	120	C-9	3.50	2.50	8000	90						Clear-Sign, Group Replacement		
T6	Cand	15	13390	15T6	120	60	C-7A	3.06	1.56	2000	107						Clear-Exit		
		15	13402	15T6	145	60	C-7A	3.06	1.56	1500	102						Clear-Exit		
		15	22114	15T6C-CD	145	120	C-7A	3.06	1.56	1500	102						Clear-Exit, Blister Card		
T7	Cand	15	13494	15T7C	120	120	C-7A	2.25	1.50	3000	108						Clear-Signal Light, Appliance		
T7	DC Bay	15	35154	15T7DC CARD	120	240	C-7A	2.25	1.31		108						Clear-Appliance, 12-Pack		
T7	Inter	15	35153	15T7N CARD	120	240	C-7A	2.25	1.56		108						Clear-Appliance		
<b>15/135/150 Watts</b>																			
A21	Med	15/135/150	23068	15/150-SECURITY	120	60	C-2R/CC-8	5.25	3.87	1200	75/2080/2155			35000	2b, 9c, 9j		Security 3-Way, Soft-White		
<b>18 Watts</b>																			
S11	SC Bay BA15s	18	13655	18S11/15C	10	120	CC-6	2.37	1.25	2000	200						Clear-Railway Signal Light		
<b>20 Watts</b>																			
T6.5	DC Bay	20	34241	20T6.5/2DC/F	120	60	C-8	5.56		5000	90						Frost-Exit Light		
T6.5	Inter	20	34272	20T6.5/2/F	120	60	C-8	5.50		7000	90						Frost-Exit Light		
<b>25 Watts</b>																			
A19	Med	25	97478	25A/CL-2PK	120	24	CC-6	4.25	2.50	2500	215							Clear	
		25	97857	25A/CL/2PK-130V	130	24	CC-6	4.25	2.50	2500	215							Clear	
		25	97864	25A/2PK-130V	130	24	CC-6	4.25	2.50	2500	215							Inside Frost	
		25	97492	25A/W-2PK	120	24	CC-6	4.25	2.50	2500	210							Soft White	
		25	16333	25A/TP-CD 6PK	120	24	C-9	3.87	2.37	2000								Transp. Purple-Party Light	
		25	16335	25A/TY-CD 6PK	120	24	C-9	3.87	2.37	2000								Transp. Yellow-Party Light	
		25	22731	25A/TP 6 PK	120	120	C-9	3.87	2.37	2000								Transp. Purple-Party Light	
		25	49728	25A/TY 6PK	120	120	C-9	3.87	2.37	2000								Transp. Yellow-Party Light	
		25	49724	25A/TB 6PK	120	120	C-9	3.87	2.37	2000								Transp. Blue-Party Light	
		25	22732	25A/TE 6PK	120	120	C-9	3.87	2.37	2000								Transp. Teal-Party Light	
		25	49725	25A/TG 6PK	120	120	C-9	3.87	2.37	2000								Transp. Green-Party Light	
		25	22730	25A/TPK 6PK	120	120	C-9	3.87	2.37	2000								Transp. Pink-Party Light	
		25	49727	25A/TR 6PK	120	120	C-9	3.87	2.37	2000								Transp. Red-Party Light	
		25	46645	25A/SG/CD-PQ1/5	120	25	CC-6	4.25	2.50	1500									Stained Glass
		25	73256	25A/SG/CD2-PK3	120	25	CC-6	4.25	2.50	1500									Stained Glass
R14	Inter	25	73280	25R14/N/CD-3PK	120	3	CC-2V	2.56		1500					5e		Reflector-Light, Inside Frost		
		25	18230	25R14N	130	120	CC-2V	2.56		1500	180				5e		Reflector-Light, Inside Frost		
R14	SC Bay B15	25	33405	25R14SC/SP	12	120	CC-8	2.62		2000	200				5e		Reflector Spot, Light I.F.		
S11	SC Bay BA15s	25	14575	25S11/4SC	10	120	CC-6	2.37	1.25	1000	360						Clear-Railway, Signal Light		
T6.5	DC Bay	25	14676	25T6.5/2DC	120	60	C-8	5.56		1000	220						Clear-Appliance, Scale Illuminator		
		25	14678	25T6.5/2/DC	130	60	C-8	5.56		1000	244						Clear-Appliance, Scale Illuminator		
		25	14685	25T6.5/2DC/F	130	60	C-8	5.56		1000	240						Frost-Appliance, Scale Illuminator		

For the most up-to-date product information, see [www.gelighting.com](http://www.gelighting.com). To convert inches to millimeters, multiply by 25.4. All warning and caution notices found at the end of this section (page 1-18).

Bulb Shape	Base	Watts	Order Code	Description	Volts	Case Qty	Filament Design	MOL (in)	LCL (in)	Rated Life (hrs)	Lumens Initial	Color Temp K	CBCP	Beam Spread	Warning and Caution Notices	Reduced Wattage	Additional Information		
<b>Incandescent Lamps (continued)</b>																			
<b>25 Watts (continued)</b>																			
T6.5	Inter	25	14639	25T6.5/2	120	60	C-8	5.50		1000	220						Clear-Showcase		
		25	14641	25T6.5/2	130	60	C-8	5.50		1000	244						Clear-Showcase		
		25	14668	25T6.5/2/F	130	60	C-8	5.50		1000	240						Frost-Showcase		
T7	DC Bay	25	14741	25T7DC	120	60	C-7A	2.25	1.31	1000	195						Clear-Appliance		
T7	Inter	25	10692	25T7N-CD 6PK	120	240	C-7A	2.25	1.56	1000	195						Clear-Appliance		
		25	14791	25T7N	120	60	C-7A	2.25	1.56	1000	195						Clear-Appliance		
T10	Med	25	45144	25T10 CD1-5PK	130	25	C-8	5.62		1000	248						Clear-Display Light		
		25	45513	25T10/F CD1-5PK	130	25	C-8	5.62		1000							Frost-Display Light		
<b>27 Watts</b>																			
R20	Med	27	47681	27R20/FL/LL 6PK	120	30	CC-6	3.93		2500	190						Long Life Reflector-Indoor Spotlight		
<b>30 Watts</b>																			
A15	Med	30	14129	30A15	130	120	C-9	3.50	2.37	5000	215						I.F. Changing, Message Sign		
		30	15291	30A15/CL	130	120	C-9	3.50	2.37	5000	215						Clear Changing, Message Sign		
		30	19358	30A15/8	130	120	C-9	3.50	2.37	8000	180						I.F.-Sign		
R20	Med	30	14891	30R20/1-6PK	120	30	CC-6	3.93		2000	200				5b, 9k		Indoor Reflector		
		30	46848	30R20/1	130	30	C-9	3.93		2000	200				5b, 9k		Indoor Reflector-Light I.F.		
		30	46849	30R20/6	130	30	C-9	3.93		6000	145				9d		Reflector-Light I.F.-Flashing Message Sign		
<b>30/70/100 Watts</b>																			
A21	Med	30/70/100	97493	30/100-1PK	120	12	C-2R/CC-8	5.25	3.88	1200	305/995/1300				2b, 5c, 9c, 9j		Soft-White, 3-Way		
		30/70/100	97784	30/100RVL-PQ1/12	120	12	C-2R	5.25	3.88	1200	220/740/960				2b, 9c, 9j		Reveal® Soft-White, 3-Way		
<b>34 Watts</b>																			
A19	Med	34/30	97848	40A/34WMM	130/120	24	CC-6	4.43	3.12	2000/5400	365/270						Watt-Miser® Diffuse Coating		
<b>38 Watts (Complies with California Title 20 Regulations)</b>																			
A19	Med	38	70688	38A 48PK	120	144	CC-6	4.43	3.12	1000	465							Inside Frost	
		34/38	71950	38A/130V-4PK	130/120	144	CC-6	4.43	3.13	2000/5400	390/290							Inside Frost	
		38	71958	38A/W-4PK	120	144	CC-6	4.43	3.12	1000	455							Soft White	
		38	71978	38A/CL-2/12PK	120	24	CC-6	4.43	3.12	1500	440							Clear	
		34/38	71985	38A/CL/2PK-130V	120/130	24	CC-6	4.43	3.13	1500/4000	435/310								Clear
		<b>40 Watts</b>																	
A15	Med	40	15199	40A15	120	120	C-9	3.50	2.37	1500	1500							Clear-Appliance and Oven Service, Vibration Resistant	
		40	15206	40A15 CARD 12PK	120	60	C-9	3.50	2.37	1500	415							Clear-Appliance and Oven Service, Vibration Resistant	
		40	21188	40A15 CD/2	120	60	C-9	3.50	2.37	1500	415							Clear-Appliance and Oven Service, Vibration Resistant	
		40	27495	40A15/F/CD	120	60	C-9	3.50	2.37	1500	355							Frosted-Appliance and Oven Service, Vibration Resistant	
		40	27451	40A15/F 120PK	120	120	C-9	3.50	2.37	1500	355							Frost	
		40	73187	40A15/RVL/CD2-6PK	120	6	C-9	3.50	2.37	1000	320							Reveal®	
		40	20451	40A15/CF CD2	120	60	C-9	3.50	2.37	1500	415							Clear-Ceiling Fan, Vibration Resistant	
		40	47260	40A15/CF/CD4-6PK	120	30	C-9	3.50	2.37	1500	415							Clear-Ceiling Fan, Vibration Resistant	
		40	20452	40A15/W/CF CD2	120	60	C-9	3.50	2.37	1500	355							White-Ceiling Fan, Vibration Resistant	
		40	73184	40A15/CF/RVCD2-6P	120	6	C-9	3.50	2.37	1000</									

# Incandescent Lamps

Bulb Shape	Base	Watts	Order Code	Description	Volts	Case Qty	Filament Design	MOL (in)	LCL (in)	Rated Life (hrs)	Lumens Initial	Color Temp K	CBCP	Beam Spread	Warning and Caution Notices	Reduced Wattage	Additional Information
<b>Incandescent Lamps (continued)</b>																	
<b>40 Watts (continued)</b>																	
A15	Cand	40	71393	40A15/CA/C/CF-CD2	120	6	C-7A	3.50	2.37	1500	305						Clear-Ceiling Fan, Vibration Resistant
		40	71394	40A15/CA/W/CF-CD2	120	6	C-7A	3.50	2.37	1500	230						White-Ceiling Fan, Vibration Resistant
A19	Med	40	97470	40A/CL-2PK	120	24	CC-6	4.43	3.12	1500	480						Clear
		40	13255	40A 48PK	120	144	CC-6	4.43	3.12	1000	505						Standard
		40	13257	40A/W 48PK	120	144	CC-6	4.43	3.12	1000	490						Standard
		40	48687	40A/RVL 48PK	120	144	CC-6	4.43	3.12	1000	360						Reveal® Soft-White
		40	81869	40A/CL/RVL 24PK	120	120	CC-6	4.43	3.12	1000	370						Reveal® Clear
		40	97480	40A/Y-2/10PK	120	20			4.43	3.12							
R14	Inter	40	25777	40R14/N/CD	120	30	CC-2V	2.68		1500				2a, 5e			Indoor Reflector
R14	Med	40	25776	40R14/CD	120	30	CC-2V	2.18		1500				2a, 5e			Indoor Reflector
R16	Med	40	73279	40R16/CD-3PK	120	30	CC-6	3.37		1500				5b, 9k			Reflector
S11	Inter	40	15734	40S11N/1/F	120	120	C-9	2.31	1.62	500	440				5b		Frost
		40	35156	40S11N/1 CARD	120	240	C-9	2.31	1.62	500	440				5b		Clear-12-Card Pack
T6.5	Inter	40	15740	40T6 1/2/2	120	60	C-8	5.50		750	420						Clear-Refrigerator
		40	44422	40T6 1/2/2CD1-6PK	120	30	C-8	5.50		750	420						Clear-Appliance
		40	15742	40T6 1/2/2F	120	60	C-8	5.50		750	420						Frost-Appliance
		40	15852	40T10	120	120	C-8	5.62		1000	420						Clear-Showcase
T10	Med	40	15892	40T10/F	120	120	C-8	5.62		1000	415						Frost-Showcase
		40	45145	40T10/F CD1-5PK	120	25	C-8	5.62		1000	415						Frost-Display Light
		40	45514	40T10/CL CD1-5PK	120	25	C-8	5.62		1000	420						Clear-Display Light
		40	48707	40T10/RVL CD1	120	25	C-8	5.63		1000							Reveal® - Clear
		40	48709	40T10/F/RVL CD1	120	25	C-8	5.63		1000							Reveal® - Frost
		<b>45 Watts</b>															
BR30	Med	45	20330	45R/FL/MI-1 6PK	120	30	CC-6	5.37		2000	485			300	2a, 5e, 9k	➔	Reflector Flood
		45	26804	45R30/FL/LL 6PK	120	30	CC-6	5.37		2500	450				2a, 5e, 9k	➔	Reflector Flood-Long Life
R20	Med	45	47682	45R20/FL/LL 6PK	120	30	CC-6	3.31		2500	400				2a, 5e, 9k	➔	Long Life Indoor Floodlight
		45	73026	45R20/YR	120	6	CC-6	3.31		1500	350				2a, 5e, 9k	➔	Indoor Reflector
		45	73025	45R20/YR-PK2/3	120	3	CC-6	3.31		1500	350				2a, 5e, 9k	➔	Indoor Reflector
		45	73029	45R20/130V	130/120	30	CC-6	3.31		2000/4000					2a, 5e, 9k	➔	Indoor Reflector
		45	73439	45R20/RVL PK1/6	120	30	CC-6	3.31		2000					2a, 5e, 9k	➔	Indoor Reflector
		<b>50 Watts</b>															
A19	Med	50	16201	50A19/RS/SH	75	120	C-9	3.87	2.50	1000	545				2a, 5a		Long Life Indoor Spotlight
ER30	Med	50	47878	50ER30/PK	120	24	CC-6	6.25		2000	480				2a, 2b, 5e		Elliptical Reflector - Pink
P25	3C Mog E39D	50	16535	50/50P25/28	120	60	C-5/C-9	5.06	3.31	750	400				9c		Clear-2-filament Marine Running Light, BB
R20	Med	50	14888	50R20/PL/1-6PK	120	30	CC-6	3.93		2000					2a, 5e, 9k		Reflector Plant Light
R20	Med	50	22752	50R20/BLB 6PK	120	6	CC-6	3.93		1000					2a, 2f, 5b, 7a, 7c, 9k		Blacklight Reflector
		50	46854	50R20/HP/1	120	30	CC-6	3.93		2000					2a, 5e		Reflector, Hot Pink
		50	46853	50R20/PK/1	130	30	CC-6	3.93		2000					2a, 5e		Reflector, Pink
		50	48038	50R20/FUS 130V	130	30	CC-6	3.93		2000					2a, 5e		Reflector, Fusia
T12	Med	50	16726	50/50T12	115	24	C-5/C-9	5.31	3.00	750	400						Clear-2-filament Marine Running Light, BB
<b>50/100/150 Watts</b>																	
A21	Med	50/100/150	97494	50/150-1PK	120	12	CC-8	5.25	3.88	1200	615/1540/2155				2b, 9j		Soft-White, 3-Way
		50/100/150	97763	50/150-2PK	120	6	CC-8	5.25	3.88	1200	615/1540/2155				2b, 9j		Soft-White, 3-Way
		50/100/150	97785	50/150RVL-1/12PQ	120	12	CC-8	5.25	3.88	1200	450/1150/1600				2b, 9j		Reveal®, Soft-White 3-Way
		50/100/150	97469	50/150/RVL-2PK	120	6	CC-8	5.25	3.875	1200	450/1150/1600				2b, 9j		Reveal®, Soft-White 3-Way
		50/100/150	97781	50/150/LL-1/12PK	120	12	CC-8	5.25	3.87	2400	500/1350/1850				2b, 9j		Long Life, Soft-White 3-Way
<b>50/200/250 Watts</b>																	
A21	Med	50/200/250	97482	50/250/1-1PK	120	12	CC-8/CC-25	5.25	3.87	1200	620/3335/3955				2b, 9c, 9j		Soft-White, 3-Way

For the most up-to-date product information, see [www.gelighting.com](http://www.gelighting.com). To convert inches to millimeters, multiply by 25.4. All warning and caution notices found at the end of this section (page 1-18).

Bulb Shape	Base	Watts	Order Code	Description	Volts	Case Qty	Filament Design	MOL (in)	LCL (in)	Rated Life (hrs)	Lumens Initial	Color Temp K	CBCP	Beam Spread	Warning and Caution Notices	Reduced Wattage	Additional Information			
<b>Incandescent Lamps (continued)</b>																				
<b>52 Watts</b>																				
A19	Med	52/46	97849	60A/52WM-130V	130/120	24	CC-8	4.43	3.12	1000/2600	710/530					➔	Watt-Miser® Diffuse Coating			
<b>57 Watts (Complies with California Title 20 Regulations)</b>																				
A19	Med	57	71909	57A 48PK	120	144	CC-6	4.43	3.12	1000	780						➔	Inside Frost		
		57/50	71951	57A/130V-4PK	130/120	144	CC-8	4.43	3.12	1200/3200	760/570						➔	Inside Frost		
		57	71959	57A/W-4PK	120	144	CC-6	4.43	3.12	1000	770						➔	Soft-White		
		57	71979	57A/CL-2/12PK	120	24	CC-6	4.43	3.12	1000	790						➔	Clear		
		57/50	72248	57A/CL/2PK-130V	130/120	24	CC-8	4.43	3.12	1200/3200	760/575						➔	Clear		
		57	71970	57A/W/LL50-2PK	120	24	CC-8	4.43	3.12	1500	765						➔	Soft-White, Long Life		
<b>60 Watts</b>																				
A19	Med	60	97490	60A/CL-2PK	120	24	CC-6	4.43	3.12	1000	870							Clear		
		60	41026	60A 48PK	120	144	CC-6	4.43	3.12	1000	865							Standard		
		60/53	97858	60A/2PK-130V	130/120	24	CC-6	4.43	3.12	1000/2600	850/640							Inside Frost		
		60	41028	60A/W 48PK	120	144	CC-6	4.43	3.12	1000	840							Soft-White		
		60	48688	60A/RVL 48PK	120	144	CC-8	4.43	3.12	1000	630							Reveal® Soft-White		
		60	73188	60A/CL/RVL-PK24	120	120	CC-6	4.43	3.12	1000	650							Reveal® Clear		
		60	97496	60A/W/LL-2PK	120	24	CC-6	4.43	3.12	1500	820							Soft-White		
		60	22361	60A/COMM 24PK	120	24	CC-6	4.43	3.12	1000	855							Inside Frost		
		60/53	72529	60A/RS130-PK2/12	130/120	24	C-7A	4.43	3.12	2000/5400	500/380					2a, 5e		Rough Service		
		60/53	72549	60A/RS/STG-T2/12	130/120	24	C-7A	4.43	3.12	2000/5400	500/380					2a		Rough Service Saf-T-Gard®		
		60	97483	60A/SPK-2PK	120	24	CC-6	4.43	3.12	1000	675					2b		Pink		
		60	72816	60A/SPK-2/10PK	120	20	CC-6	4.43	3.12	1000	675					2b		Soft Pink		
		60	97495	60A/Y-2PK	120	24	CC-6	4.43	3.12	1000	550							Yellow-Bug Light		
		60	25905	60A/BLB 6PK	120	30	C-9	4.43		1000						2a, 2f, 5b, 7a, 7c, 9k		Blacklight		
		60	73277	60A/BLB/TW-6PK	120	6	C-9	4.43	3.12	1000						2a, 2f, 5b, 7a, 7c, 9k		Blacklight		
		60	73181	60A/NET-6PK	120	6	CC-8	4.44	3.13	1000										
		60	41624	60A/PL 6PK	120	30	CC-6	4.43	3.12	1000	630					5e		Plant		
		A15	Med	60	17759	60A15/CF CD2	120	60	C-9	3.50	2.37	1500	650							Clear-Ceiling Fan and Appliance, Vibration Resistant
				60	47259	60A15/CF/CD4-6PK	120	30	C-9	3.50	2.38	1500	650							Clear, Ceiling Fan
				60	14029	60A15/W/CF-CD2	120	60	C-9	3.50	2.37	1500	650							White-Ceiling Fan, Vibration Resistant
60	73186			60A15/CF/RVL/CD2-6PK	120	6	C-9	3.50	2.38	1500	480							Reveal® Ceiling Fan, Vibration Resistant		
60	73182			60A15/W/CF/RVL/CD2-6PK	120	6	C-9	3.50	2.38	1500	465							Reveal® Soft-White		
60	46888			60A15CF/STGPQ2/6	120	30	C-9	3.50	2.37	1500	650									

# Incandescent Lamps

Bulb Shape	Base	Watts	Order Code	Description	Volts	Case Qty	Filament Design	MOL (in)	LCL (in)	Rated Life (hrs)	Lumens Initial	Color Temp K	CBCP	Beam Spread	Warning and Caution Notices	Reduced Wattage	Additional Information	
<b>Incandescent Lamps (continued)</b>																		
<b>65 Watts (continued)</b>																		
BR30	Med	65	46858	65R30/FL/CLV	120	30	CC-6	5.37		2000					2a, 2b, 5e, 9a, 9l		Reflector-covRguard® Coated	
		65	47723	65R30FL/STGPO1/6	120	30	CC-6	5.37		2000					2a, 2b, 5e, 9k, 9a, 9l	➔	Indoor Flood Light-Saf-T-Gard®	
		65	41837	65R30/SP/HP	120	30	CC-6	5.37		2000					2a, 5e, 9k		Indoor Reflector, Hot Pink	
		65	26803	65R30/FL/PAK	120	30	CC-6	5.37		2000					2a, 5e, 9k	➔	Reflector - Pink	
		65	26641	65R30/FL/B	120	30	CC-6	5.37		2000					2a, 5e, 9k	➔	Reflector - Blue	
		65	26642	65R30/FL/G	120	30	CC-6	5.37		2000					2a, 5e, 9k	➔	Reflector - Green	
		65	26645	65R30/FL/Y	120	30	CC-6	5.37		2000					2a, 5e, 9k	➔	Reflector - Yellow	
		65	20996	65R30/PL-1 6PK	120	30	CC-6	5.37		2000					2a, 5e, 9k	➔	Reflector-Plant Light, BB	
		65	46855	65R30/FL	130	30	CC-6	5.37		2000		725			2a, 2b, 5e, 9k	➔	Watt-Miser® Reflector	
		65	46856	65R30/SP	130	30	CC-6	5.37		2000		725			2a, 2b, 5e, 9k	➔	Watt-Miser® Reflector	
		65	46857	65R30/FL/PAK	130	30	CC-6	5.37		2000					2a, 2b, 5e, 9k	➔	Watt-Miser® Reflector-Pink	
		65	48039	65R30SP/FUS 130V	130	30	CC-6	5.37		2000					2a, 2b, 5e, 9k	➔	Indoor Reflector, Fusia	
		BR40	Med	65	14016	65R40/FL/MI-6PK	120	30	CC-6	6.56		2000	730			2a, 2b, 5e, 9k		Reflector Flood
65	47683			65R40/FL/LL	120	30	CC-6	6.56		2500	650			2a, 2b, 5e, 9k		Long Life Reflector-Indoor Floodlight		
65	46861			65R40/FL	130	30	CC-6	6.56		2000	700			2a, 2b, 5e, 9k		Watt-Miser® Reflector-I.F.		
BR40	Med	65	87904	65R40FL/RVL-TP6	120	30	CC-6	6.56		2000			2a, 2b, 5e, 9k		Reveal® Reflector Flood			
<b>67 Watts</b>																		
A19	Med	67/60	97850	75A/67WM-130V	130/120	24	CC-8	4.43	3.12	1000/2600	1000/755					➔	Inside Frost	
<b>69 Watts</b>																		
A21	Med	69	17325	69A21/TS	130	120	C-9	4.37	2.43	8000	675					➔	Clear-Traffic Signal, BDTH	
<b>71 Watts (Complies with California Title 20 Regulations)</b>																		
A19	Med	71	71910	71A 48PK	120	144	CC-6	4.43	3.12	750	1075					➔	Inside Frost	
		71/63	71952	71A/130V-4PK	130/120	144	CC-8	4.43	3.12	750/1950	1050/790					➔	Inside Frost	
		71	71960	71A/W-4PK	120	144	CC-6	4.43	3.12	750	1060					➔	Soft-White	
		71	71980	71A/CL-2/12PK	120	24	CC-6	4.43	3.12	750	1090					➔	Clear	
		71	71971	71AW/LL50-2PK	120	24	CC-8	4.43	3.12	1125	1055					➔	Soft-White, Long Life	
<b>75 Watts</b>																		
A19	Med	75	97468	75A/CL-2PK	120	24	CC-6	4.43	3.12	750	1200							Clear
		75	41030	75A 48PK	120	144	CC-6	4.43	3.12	750	1190							Standard
		75/67	97859	75A/2PK-130V	130/120	24	CC-6	4.43	3.12	750/1950	1170/885							Standard
		75	41032	75A/W 48PK	120	144	CC-6	4.43	3.12	750	1170							Soft-White
		75	48689	75A/RVL 48PK	120	144	CC-8	4.43	3.12	750	830							Reveal® Soft-White
		75	81870	75A/CL/RVL 24PK	120	120	CC-6	4.43	3.12	750	885							Reveal® Clear
		75	97497	75A/W/LL-2PK	120	24	CC-6	4.43	3.12	1125	1125							Soft-White, Long Life
		75	22364	75A/COMM 24PK	120	24	CC-6	4.43	3.12	750	1180							Inside Frost
		75/67	72530	75A/RS130-PK6	130/120	6	C-7A	4.43	3.12	2000/5400	740/562				2a, 5e			Rough Service
		75/67	72550	75A/RS/STG-TP6	130/120	6	C-7A	4.43	3.12	2000/5400	740/562				2a			Rough Service, Saf-T-Gard®
A21	Med	75	17482	75A21	12	120	C-6	5.25	3.81	1000	1500				5a		Inside Frost	
		75	22748	75R30/BLB 6PK	120	6	C-9	5.37		1000				2a, 2f, 5b, 7a, 7c, 9k		Reflector Blacklight		
<b>85 Watts</b>																		
PAR38	Med Skirt	85	20945	85PAR/FL/BG 6PK	120	6	CC-6	5.31		2000					1a, 2a, 2b		Yellow-Bug Light, BB	
		85	13465	100PAR/B/85WM6PK	120	6	CC-6	5.31		2000					1a, 2a, 2b	➔	Powder Coated-Blue, BB	
		85	13472	100PAR/R/85WM6PK	120	6	CC-6	5.31		2000					1a, 2a, 2b	➔	Powder Coated-Red, BB	
		85	13473	100PAR/Y/85WM6PK	120	6	CC-6	5.31		2000					1a, 2a, 2b	➔	Powder Coated-Yellow, BB	

Bulb Shape	Base	Watts	Order Code	Description	Volts	Case Qty	Filament Design	MOL (in)	LCL (in)	Rated Life (hrs)	Lumens Initial	Color Temp K	CBCP	Beam Spread	Warning and Caution Notices	Reduced Wattage	Additional Information	
<b>Incandescent Lamps (continued)</b>																		
<b>85 Watts (continued)</b>																		
PAR38	Med Skirt	85	13474	100PAR/G/85WM6PK	120	6	CC-6	5.31		2000					1a, 2a, 2b	➔	Powder Coated-Green, BB	
<b>90 Watts</b>																		
A19	Med	90/80	97851	100A/90WM-130V	130/120	24	CC-8	4.43	3.12	1000/2600	1440/1095					➔	Inside Frost	
<b>95 Watts (complies with California Title 20 Regulations)</b>																		
A19	Med	95	71911	95A 48PK	120	144	CC-8	4.43	3.12	750	1635					➔	Standard	
		95	71915	95A-2/24PK	120	24	CC-8	4.43	3.12	750	1635					➔	Standard	
		84/95	71953	95A/130V-4PK	130/120	144	CC-8	4.43	3.12	750/1950	1600/1215					➔	Standard	
		95	71961	95A/W-4PK	120	144	CC-8	4.43	3.12	750	1610					➔	Soft-White	
		95	71981	95A/CL-2/12PK	120	24	CC-8	4.43	3.12	750	1655					➔	Clear	
		95	71972	95AW/LL50-2PK	120	24	CC-8	4.43	3.12	1125	1510					➔	Soft-White, Long Life	
<b>100 Watts</b>																		
A19	Med	100	97489	100A/CL-2PK	120	24	CC-8	4.43	3.12	750	1750							Clear
		100	41034	100A 48PK	120	144	CC-8	4.43	3.12	750	1710							Standard
		100/89	97860	100A/2PK-130V	130/120	24	CC-8	4.43	3.12	750/1950	1680/1275							Inside Frost
		100	41036	100A/W 48PK	120	144	CC-8	4.43	3.12	750	1690							Soft-White
		100	48690	100A/RVL 48PK	120	144	CC-8	4.43	3.12	750	1260							Reveal® Soft-White
		100	81871	100A/CL/RVL 24PK	120	120	CC-8	4.43	3.12	750	1300							Reveal® Clear
		100	97761	100A/W/LL-2PK	120	24	CC-8	4.43	3.12	1125	1600							Soft-White
		100	22366	100A/COMM 24PK	120	24	CC-8	4.43	3.12	750	1690							Inside Frost
		100/89	72527	100A/RS130-PK12	130/120	12	C-7A	4.43	3.12	2000/5400	1070/813				2a, 5e			Rough Service
		100	72546	100A/RS/STG-TP6	120	100	CC-8	4.43	3.12	750	1624				2a			Rough Service Saf-T-Gard®
		100	97484	100A/SPK-2PK	120	24	CC-8	4.43	3.12	1000	1330				2b			Pink
		100	97762	100A/Y-2PK	120	24	CC-8	4.43	3.12	1000	900				2b			Yellow-Bug Light
		A21	Med	100	17517	100A 60PK	277	60	C-7A	5.25	3.81	750	1250					
A23	Med	100	18512	100A23	12	120	C-6	5.93	4.43	1000	1750				5a		Inside Frost	
<b>100/200/300 Watts</b>																		
PS25	Mog	100/200/300	41459	100/300 6PK	120	30	CC-6	6.68	4.43	1200	1320/3300/4620				2b, 9c, 9j		Soft-White, 3-Way	
<b>110 Watts</b>																		
R30	Med	110	46859	110R30/FL/RS/1	120	30	C-17	5.38		2000	1080				2a		Reflector Flood, I.F. Rough Service	
<b>116 Watts</b>																		
A21	Med	116	19010	116A21/TS	130	120	C-9	4.37	2.43	8000	1280						Clear-Traffic Signal, BDTH	
<b>120 Watts</b>																		
BR40	Med	120	21000	120R40/PL-1 6PK	120		CC-6	6.56		2000					2a, 2b, 5e, 9k		Reflector Plant Light, BB	
		120	46877	120R40/FL/CLV	130	30	CC-6	6.56		1700	1550		1200		2a, 2b		Reflector-covRguard®	
		120	47725	120R40FL/STG PQ6	130	30	CC-6	6.56		1700	1550		1200		2a, 2b		Reflector-covRguard®	
<b>135 Watts</b>																		
A21	Med	135/120	12627	150A/135WM	130/120	60	CC-8	5.37	4.06	2500/6800	2340/1790					➔	Watt-Miser®-Diffuse Coating (Ratings @ 120 volts)	
<b>150 Watts</b>																		
A21	Med	150	16068	150A/CL 12PK	120	12	CC-8	5.37	4.06	750	2850							Clear
		150	10429	150A/W 12PK	120	12	CC-8	5.37	4.06	750	2780							Soft-White
		150	16703	150A/RVL	120	30	CC-8	5.37	4.06	750	1950							Reveal®
		150/133	72532	150A21/RS-PK6	130/120	30	C-17	5.37	4.06	1000/2600	2065/1580				2a, 5e			

# Incandescent Lamps

Bulb Shape	Base	Watts	Order Code	Description	Volts	Case Qty	Filament Design	MOL (in)	LCL (in)	Rated Life (hrs)	Lumens Initial	Color Temp K	CBCP	Beam Spread	Warning and Caution Notices	Reduced Wattage	Additional Information
<b>Incandescent Lamps (continued)</b>																	
<b>200 Watts (continued)</b>																	
A21	Med	200/177	25936	200A21/99/F	130/120	60	CC-8	5.37	4.06	2500/6800	3250/2500						I.F.-Extended Service (Ratings @ 120 volts)
PS30	Med	200/177	72548	200PS30RS/23/STG	130/120	60	C-9	8.06	6.00	1000/2600	3240/2495				2a, 5e		Saf-T-Guard®
<b>250 Watts</b>																	
R40	Med	250	37770	250R40/1 6PK	120	30	C-9	6.56		5000	2200				2a, 2b, 3b, 5e, 6a		Reflector-Warm Up Infrared Heat Lamp-Clear Face
		250	37771	250R40/10 6PK	120	30	C-9	6.56		5000					2a, 2b, 3b, 5e, 6a		Reflector-Chill Chaser Infrared Heat Lamp, Red, HRG
		250	46881	250R40/1/CSVG	120	30	C-9	6.56		5000	2150				2a, 2b, 3b, 5e, 6a		Clear-covRguard®, Food Warming, Reflector-Infrared
R40	Med Skirt	250	20724	250R40/4	120	24	C-9	7.43		5000				2a, 2b, 3b, 5e, 6a		Reflector Infrared Industrial-Light I.F., BB	
R40	Med	250	47724	250R40/1/STG PQ6	120	30	C-9	6.56		5000	2150				2a, 2b, 3a, 3b, 6a		Heat Lamp Saf-T-Gard® - Shatter-Resistant
		250	23423	21A/R40/FL	12	24	C-2V	6.68		1000					2b, 5a, 5e		Reflector Flood
<b>300 Watts</b>																	
PS25	Med	300/266	20863	300M	130/120	60	CC-8	6.93	5.18	750/1950	6120/4170						Clear
		300/266	20917	300M/IF	130/120	60	CC-8	6.93	5.18	750/1950	6120/4170						Inside Frost
PS35	Mog Screw	300	21025	300	130	24	C-9	9.37	7.00	1000	5820						Clear
		300	21079	300/IF	130	24	C-9	9.37	7.00	1000	5820						Inside Frost
R40	Med	300	21197	300R/SP	120	24	CC-2V	6.56		2000	3700		9000		2a, 2b, 5b, 9e		Reflector-Light I.F. HORIZ
		300	21213	300R/FL	120	24	CC-2V	6.56		2000	3700		2500		2a, 2b, 5b, 9e		Reflector-Flood I.F. HORIZ
		300	21229	300R/FL/1	120	24	CC-2V	6.75		2000	3700		1900		2a, 2b, 5b, 9e		Reflector-Flood-I.F. BB, HRG
		300/266	21215	300R/FL	130/120	24	CC-2V	6.56		2000/5400	3465/2670		2500		2a, 2b, 5b, 9e		Reflector Flood-I.F. HORIZ (Ratings @ 120 volts)
R40	Mog Screw	300	21254	300R/3FL	120	24	CC-2V	7.25		2000	3750			2a, 2b, 5b, 9e		Reflector Flood-I.F.1BB	
<b>375 Watts</b>																	
R40	Med Skirt	375	21331	375R40	115	24	C-9	7.37		5000h					2a, 2b, 3b, 5e, 6a		Reflector Infrared Industrial-Light I.F., BB
		375	21334	375R40/1	115	24	C-9	7.50		5000					2a, 2b, 3b, 5e, 6a		Reflector Infrared Industrial-Clear Face, HRG, BB
<b>400 Watts</b>																	
G30	Med	400	21363	400G/FL	120	60	C-5	5.12	3.00	800	6800				2a, 2b, 3b, 5e, 6a		Clear Flood, BDTH, BB
R40	Med	400	17542	400R40/FL	120	24	CC-2V	6.75		2000	5000				5b, 5c, 9b		Reflector Flood. Swimming Pool, BB, HRG
<b>500 Watts</b>																	
PS35	Mog Screw	500	21532	500	130	24	CC-8	9.37	7.00	1000	10850				5d, 5e		Clear, BB
R40	Mog Screw	500	21734	500R/3FL	120	24	CC-2V	7.25		2000	6500				2a, 2b, 5b, 9e		Reflector Flood-I.F. BB, HRG
		500	21736	500R/3FL	130	24	CC-2V	7.25		2000	6500				2a, 2b, 5b, 9e		Reflector Flood-I.F. BB, HRG
R40	Med	500	48316	500R40/5FL/SLV	120	24	CC-2V	6.75		2000				9k		Reflector-Swimming Pool, BB, HRG	
<b>1000 Watts</b>																	
PS52	Mog Screw	1000	22260	1000	130	12	CC-8	13	9.50	1000	23740				5d, 5e		Clear, BB
		1000	22348	1000/SBIF	120	12	C-7A	13	3.13	1000	20400						Inside Frost, BB
<b>Export Only</b>																	
<b>75 Watts</b>																	
PAR38	Med Skirt	75	14510	75PAR/FL/EX-120	120	12	CC-6	5.31		2000	765	2700	1750	33	1a, 2a, 2b		Frost
<b>85 Watts</b>																	
PAR38	Med Skirt	85	14509	100PAR/FL85WM/EX	120	6	CC-6	5.31		2000	930	2700	2000	37	1a, 2a, 2b	↔	Watt-Miser®, Flood

For the most up-to-date product information, see [www.gelighting.com](http://www.gelighting.com). To convert inches to millimeters, multiply by 25.4. All warning and caution notices found at the end of this section (page 1-18).

Bulb Shape	Base	Watts	Order Code	Description	Volts	Case Qty	Filament Design	MOL (in)	LCL (in)	Rated Life (hrs)	Lumens Initial	Color Temp K	CBCP	Beam Spread	Warning and Caution Notices	Reduced Wattage	Additional Information
<b>Export Only (continued)</b>																	
<b>120 Watts</b>																	
PAR38	Med Skirt	120	14501	150PAR/FL/120WM/	120	12	CC-6	5.31		2000	1370	2725	3600	30	1a, 2a, 2b	↔	Watt-Miser®, Flood
		120	14502	150PAR/SP/120WM/	120	12	CC-6	5.31		2000	1370	2725	9200	18	1a, 2a, 2b	↔	Watt-Miser®, Reflector
<b>150 Watts</b>																	
PAR38	Med Skirt	150	14531	150PAR/FL/EX-120	120	12	CC-6	5.31		2000	1740	2775	3100	36	1a, 2a, 2b		Flood
		150	14535	150PAR/SP/EX-120	120	12	CC-6	5.31		2000	1740	2775	12000	16	1a, 2a, 2b		Reflector
<b>Lumen Rated Traffic Signal</b>																	
<b>165 Watts</b>																	
P25	Med	165	20097	1950L/P25/TS	130	60	C-9	4.75	3.00	8000	1950						Clear-Traffic Signal (BDTH), BB
<b>Airport</b>																	
<b>30 Watts</b>																	
T10	Med PF	30	23294	6.6A/T10/1P		60	C-2V	3.93	1.50	1000	400						Clear
<b>40 Watts</b>																	
T10	Med PF	40	15921	40T10P	120	60	CC-2V	3.93	1.50	1000	400						Clear
<b>200 Watts</b>																	
T14	Med PF	200	23298	6.6A/T14P		24	C-13	5.75	2.18		4900						Clear
<b>620 Watts</b>																	
PS40	Mogul PF	620	21950	620PS40P	120	24	C-9	10.06	5.68	3000	11200						Clear
		620	21952	620PS40P	130	24	C-9	10.06	5.68	3000	11200						Clear
<b>1200 Watts</b>																	
T20	Mog Bi-Post	1200	22524	1200T20	115	12	CC-8	9.50	4.00	750	29600						Clear-Beacon, HRG
<b>Multiple Street Lighting</b>																	
<b>30 Watts</b>																	
PS25	Med	189	19939	189PS25/64	130	60	C-9	6.93	5.25	3000							Clear, BB
		205	42663	205PS25/12	125	60	C-9	6.93	5.25	12000							Clear, BB
PS35	Mog Screw	327	21307	327PS35	125	24	C-9	9.37	7.00	6000							Clear, BB
<b>Landscape Lighting</b>																	
<b>4 Watts</b>																	
T5	Wedge	4	71479	901/LAND/BP2	12	48	C-2R	1.49	0.08	500	36						
<b>7 Watts</b>																	
T5	Wedge	7	71480	918/LAND/BP2	12	48	C-2R	1.49	0.08	500	82						
<b>11 Watts</b>																	
T5	Wedge	11	71481	923/LAND/BP2	12	48	C-2R	1.49	0.08	500	157						
<b>18 Watts</b>																	
T5	Wedge	18	71482	921/LAND/BP2	12	48	C-2R	1.49	0.08	500	264						
		18	71483	921/XE/LAND/BP2	12	48	C-2R	1.49	0.08	1400	297						
<b>Decorative</b>																	
<b>3 Watts</b>																	
CA10	Cand	3	73254	3CAC/FF/CD1-6PK	120	6		4.13			2000						Flicker Flame
		3	73255	3CAM/FF/CD1-6PK	120	6		4.13			2000						Flicker Flame
<b>15 Watts</b>																	
B8	Cand	15	73262	15BC/CF/CD2-TR6	120	6	C-7A	3.87		1500							Blunt Tip, Ceiling Fan, Vibration Resistant
		15	74033	15BC/RVL/CF-T4/6	120	6	C7-A	3.87		1500							Reveal®, Blunt Tip, Ceiling Fan, Vibration Resistant
		15	48400	15BC CD2 6PK	120	30	C-7A	3.87		1500							Clear-Blunt Tip
CA8	Cand	15	48396	15CAC CD2 6PK	120	30	C-7A	4.12		1500							Bent Tip
F10	Cand	15	48395	15FC CD2 6PK	120	30	C-7A	4.37		1500							Clear-Chandelier
		15	73283	15FC/AU/CD2-PK6	120	6	C-7A	4.37		1500							Auradescent
<b>25 Watts</b>																	
B8	Cand	25	73263	25BC/CF/CD2-TR6	120	6	C-7A	3.87		1500							Blunt Tip, Ceiling Fan, Vibration Resistant
			74034	25BC/RVL/CF-T4/6	120	6	C-7A	3.87		1500							Reveal®, Blunt Tip, Ceiling Fan, Vibration Resistant

For the most up-to-date product information, see [www.gelighting.com](http://www.gelighting.com). To convert inches to millimeters, multiply by 25.4. All warning and caution notices found at the end of this section (page 1-18).

Incandescent  
Halogen  
High Intensity Discharge  
Fluorescent  
Compact Fluorescent  
Ballast  
LED Lamps and Systems  
Stage and Studio  
Miniature and Sealed Beam  
Projection

# Incandescent Lamps

Bulb Shape	Base	Watts	Order Code	Description	Volts	Case Qty	Filament Design	MOL (in)	LCL (in)	Rated Life (hrs)	Lumens Initial	Color Temp K	CBCP	Beam Spread	Warning and Caution Notices	Reduced Wattage	Additional Information				
<b>Decorative (continued)</b>																					
<b>25 Watts (continued)</b>																					
B10	Cand	25	15787	25BC 25PK	120	200	C-7A	3.75		1500							Clear, Blunt Tip				
		25	45083	25BC CD4	120	30	C-7A	3.75			1500						Clear, Blunt Tip				
		25	74034	25BC/RVL/CF-T4/6	120	6	C-7A	3.75			1500						Reveal® Clear Blunt Tip, Ceiling Fan, Vibration Resistant				
B13	Med	25	41863	25BM/CD4	120	6	C-9	4.62		1500							Clear Ceiling Fan, Chandelier				
CA10	Cand	25	15777	25CAC 25PK	120	200	CC-2V	4.12		1500							Clear, Bent Tip				
		25	16046	25CAC/F CD4	120	30	CC-2V	4.12			1500						Clear, Bent Tip				
		25	40045	25CAC/L	120	120	CC-2V	4.12			4000						Clear, Bent Tip, Brass Base, LL				
CA10	Cand	25	16365	25CAC/L/BB-CD4	120	24	CC-2V	4.12		4000							Clear, Bent Tip				
		25	16045	25CAC CARD4	120	30	CC-2V	4.12			1500						Clear, Bent Tip				
CA9	Med	25	72773	25CAM/CL/CD6-5PK	120	6	CC-2V	4.56		1500							Clear, Bent Tip				
F15	Med	25	72810	25FM/CF/CD2-4P	120	4	C-9	4.37		1500							Clear, Flame Ceiling Fan				
		25	72805	25FM/A/CF/CD2-4PK	120	4	C-9	4.37		1500							Ceiling Fan				
		25	72806	25FM/AU/CF/CD2-4PK	120	4	C-9	4.37		1500							Auradescent Ceiling Fan				
		25	72804	25FM/W/CF/CD2-4PK	120	4	C-9	4.37		1500							White, Ceiling Fan				
		25	11303	25GC 12PK	120	120	CC-2V	3.00			1500				5e, 9d			Clear, Globe			
G16.5	Cand	25	72800	25GC/CL/CD2-4PK	120	4	CC-2V	3.00		1500							5e, 9d	Clear, Globe			
		25	72801	25GC/AU/CD2 4PK	120	4	CC-2V	3.00		1500							5e, 9d	Clear, Globe			
		25	44412	25GC/W PQ2/6	120	30	CC-2V	3.00		1500							5e, 9d	White, Globe			
G16.5	Cand	25	39679	25GC/W 12PK	120	120	CC-2V	3.00		1500								5e, 9d	White, Globe		
		25	71716	25GC/RVL/CD2-4PK	120	4	CC-2V	3.00		1500								5e, 9d	Reveal® Globe		
G16.5	Med	25	31106	25GM/CL-PQ2/6	120	30	CC-2V	3.00		1500								5e, 9d	Clear-Globe, Medium Base		
G16.5	Med	25	31107	25GM/W-PQ2/6	120	30	CC-2V	3.00		1500									5e, 9d	White-Globe, Medium Base	
		25	12982	25G25/W 6PK	120	6	CC-6	4.50		1500										White-Globe	
G25	Med	25	12983	25G25 6PK	120	6	CC-6	4.50		1500											White-Globe
		25	12983	25G25 6PK	120	6	CC-6	4.50		1500											White-Globe
<b>40 Watts</b>																					
B8	Cand	40	73264	40BC/CF/CD2-TR6	120	6	C-7A	3.87		1500								Clear, Blunt Tip, Ceiling Fan			
		40	74035	40BC/RVL/CF-T4/6	120	6	C-7A	3.87		1500								Reveal®, Clear, Blunt Tip, Ceiling Fan			
B10	Cand	40	15788	40BC 25PK	120	200	CC-2V	3.75		1500								Clear, Blunt Tip			
		40	19981	40BC CARD4	120	30	CC-2V	3.75		1500								Clear, Blunt Tip			
		40	48701	40BC/RVL CD2	120	30	CC-2V	3.75		1500								Reveal® Clear, Blunt Tip			
		40	74035	40BC/RVL/CF/T4/6	120	6	C-7A	3.75		1500								Reveal® Clear, Ceiling Fan			
B13	Med	40	27310	40BM/CD4	120	6	C-9	4.62		1500								Clear-Blunt Tip			
		40	72807	40BFM/CD2-4PK	120	4	C-9	4.62		1500											
		40	72780	40BM/RVL/CD2-4PK	120	4	C-9	4.62		1500								Clear, Bent Tip			
		40	16049	40CAM CARD4	120	30	CC-2V	4.56		1500								Clear, Bent Tip			
CA10	Cand	40	48342	40CAM/L/BB CD4	120	30	CC-2V	4.56		4000								Post Light			
		40	15778	40CAC 25PK	120	200	CC-2V	4.12		1500								Clear, Bent Tip			
		40	16047	40CAC CARD4	120	30	CC-2V	4.12		1500								Clear, Bent Tip			
		40	48341	40CAC/L/BB-CD4	120	30	CC-2V	4.12		3000								Clear, Bent Tip, Brass Base, Long Life			
F15	Med	40	16048	40CAC/F CARD4	120	30	CC-2V	4.12		1500								Frost, Bent Tip			
		40	72811	40FM/CF/CD2-4PK	120	4	C-6	4.37		1500								Clear, Flame, Ceiling Fan, Vibration Resistant			
		40	72809	40FM/AU/CF/CD2 4PK	120	4	C-6	4.37		1500								Auradescent, Flame, Ceiling Fan, Vibration Resistant			
40	72808	40FM/W/CF/CD2-4PK	120	4	C-6	4.37		1500									White, Flame, Ceiling Fan, Vibration Resistant				

Bulb Shape	Base	Watts	Order Code	Description	Volts	Case Qty	Filament Design	MOL (in)	LCL (in)	Rated Life (hrs)	Lumens Initial	Color Temp K	CBCP	Beam Spread	Warning and Caution Notices	Reduced Wattage	Additional Information					
<b>Decorative (continued)</b>																						
<b>40 Watts (continued)</b>																						
G16.5	Cand	40	14958	40GC 12PK	120	120	CC-2V	3.00		1500								5e, 9d	Clear, Globe, BDTH			
		40	72802	40GC/CL/CD2-4PK	120	4	CC-2V	3.00			1500								Clear, Globe, BDTH			
		40	72803	40GC/AU/CD2-4PK	120	4	CC-2V	3.00			1500								5e, 9d	Auradescent, Globe, BDTH		
		40	72776	40GC/RVL/CD2-4PK	120	4	CC-2V	3.00			1500									5e, 9d	Reveal®	
		40	72209	40GC/W/CD2-4PK	120	4	CC-2V	3.00			1500										5e, 9d	White-Globe, BDTH
G16.5	Med	40	48705	40GC/W/RVL CD2	120	30	CC-2V	3.00		1500										5e, 9d	Reveal® White-Globe, BDTH	
		40	31109	40GM/CL-PQ2/6	120	30	CC-2V	3.00		1500										5e, 9d	Clear, Globe, Medium Base, BDTH	
G16.5	Med	40	31110	40GM/W-PQ2/6	120	30	CC-2V	3.00		1500										5e, 9d	White, Globe, Medium Base, BDTH	
		40	31110	40GM/W-PQ2/6	120	30	CC-2V	3.00		1500										5e, 9d	White, Globe, Medium Base, BDTH	
<b>60 Watts</b>																						
G25	Med	40	12979	40G25/W 6PK	120	6	CC-6	4.50		1500											White, Globe	
		40	12980	40G25 6PK	120	6	CC-6	4.50		1500											Clear, Globe	
		40	48694	40G25C/RVL PQ1/6	120	6	CC-6	4.50		1500												Reveal®
		40	48695	40G25W/RVL PQ1/6	120	6	CC-6	4.50		1500												Reveal®
G40	Med	40	36191	40G40/W 6PK	120	6	CC-6	6.93		2500											White, Globe	
		40	27298	60BC/CD4	120	30	CC-2V	3.75		1500											Clear, Blunt Tip	
B10	Cand	60	74036	60BC/RVL/CF-T4/6	130	6	C-7A	3.75		1500											Reveal® Clear, Ceiling Fan, Blunt Tip	
		60	27497	60BM/CD4	120	6	C-9	4.62		1500											Clear, Blunt Tip	
B13	Med	60	72781	60BM/RVL/CD2-4PK	120	4	C-9	4.62		1500											Reveal®, Blunt Tip	
		60	21009	60CAM CARD4	120	30	CC-2V	4.56		1500											Clear, Bent Tip, BDTH	
CA10	Cand	60	15781	60CAC 25PK	120	200	CC-2V	4.12		1500											Clear, Bent Tip	
		60	16050	60CAC CARD 4	120	30	CC-2V	4.12		1500											Clear, Bent Tip	
		60	16051	60CAC/F CARD4	120	30	CC-2V	4.12		1500											Frost, Bent Tip	
G16.5	Cand	60	72777	60GC/CD2-4PK	120	4	CC-2V	3.00		1500										5e, 9d	Clear, Globe	
G16.5	Cand	60	44723	60GC/W PQ2/6	120	30	CC-2V	3.00		1500										5e, 9d	White, Globe	
G16.5	Med	60	31114	60GM/CL-PQ2/6	120	30	CC-2V	3.00		1500											5e, 9d	Clear, Globe, Medium Base, BDTH
		60	31115	60GM/W-PQ2/6	120	30	CC-2V	3.00		1500										5e, 9d	White, Globe, Medium Base, BDTH	
		60	42360	60G25C/RVL PQ1/6	120	6	CC-6	4.50		1500												Reveal®, Clear-Globe
G25	Med	60	42361	60G25W/RVL PQ1/6	120	6	CC-6	4.50		1500												Reveal®, White - Globe
		60	14846	60G25 6PK	120	6	CC-6	4.50		1500												Clear, Globe
		60	14848	60G25/W 6PK	120	6	CC-6	4.50		1500												White - Globe
		60	14850	60G30/W 6PK	120	24	CC-9	5.00		2500												White - Globe, Retail Pack
G40	Med	60	14187	60G40 6PK	120	6	CC-6	6.93		2500												

# Incandescent Lamps

## Warning and Caution Notices

### 1

**⚠ WARNING**

**Risk of electric shock**

- a. Turn off power before inspection, installation or removal

### 2

**⚠ WARNING**

**Risk of fire**

- a. Keep combustible materials away from lamp
- b. Use in fixture rated for this product
- c. Use in fixture rated for this product – see instructions
- d. Operate base down to horizontal only
- e. Keep away from bed coverings, drapes and other combustible materials
- f. Do not use in enclosed fixture or with lamp shade
- g. Use in a high intensity fixture rated for this product
- h. Do not use as a night light
- i. Burning position base down only

### 3

**⚠ WARNING**

**Lamp emits IR radiation which may cause eye injury**

- a. Use in fixture approved for this product
- b. Do not use on infant, disabled, sleeping, or unconscious person/ animal unable to avoid potential injury

### 4

**⚠ WARNING**

**Pressurized lamp – unexpected rupture may cause injury, fire, or property damage**

- a. Use eye protection when handling lamp
- b. Avoid direct water/liquid contact
- c. Use in enclosed fixture rated for this product
- d. Operate lamp only in specified position

### 5

**⚠ WARNING**

**Unexpected lamp rupture may cause injury, fire, or property damage**

- a. Do not exceed rated voltage
- b. Avoid direct water/liquid contact
- c. Use in enclosed fixture rated for this product
- d. Do not use lamp if outer glass is scratched or broken
- e. Avoid direct water, liquid, or metal contact

### 6

**⚠ WARNING**

**Risk of burn**

- a. Do not touch operating lamp

### 7

**⚠ CAUTION**

**Risk of burn**

- a. Allow lamp to cool before handling
- b. Allow lamp/fixture to cool before handling
- c. Do not touch operating lamp

### 8

**⚠ CAUTION**

**Lamp may shatter and cause injury if broken**

- a. Do not use excessive force when installing lamp

### 9

**Operating Instructions**

- a. Burning position – base up
- b. Burning position – horizontal
- c. Burn base down only
- d. Burn base down to horizontal
- e. For best performance burn lamp within 45 degrees of vertical base up
- f. For best performance burn within 45 degree of base down to horizontal
- g. For best performance operate base up within 30° of vertical
- h. For best performance burn base down
- i. Do not burn in base up position
- j. To produce all three levels of light, this lamp should be tightened firmly, but not forcibly, in the socket to assure that all contacts are connected
- k. Should not be used in equipment where the base lamp will exceed 550°F (260°C)
- l. Will operate in any burning position, but fixed-socket usage other than base up, or continuous burning in any position in ambient temperatures above 150°F (66°C), may result in some loss of protective coating
- m. Reflectors and accessories may raise bulb temperature
- n. For use with heat-resistant connector supported by bulb rim or metal shell of base
- o. For best performance replace lamp if it blisters or darkens

## Cross-Reference

GE Description Order This GE Lamp	Osram/Sylvania Description If you currently use these lamps	Philips Description If you currently use these lamps
<b>Incandescent Lamps</b>		
356/5 130V	356/5 130V	356/5 120-130V
4C7	4C7/BL/2PK	BC-4C7
4C7/W	4C7/W/2PK 120V	BC4C7/W
10S11N	10S11N/CL	10S11N
10S11N/F	10S11/F	10S11N/F
15S14/GR/CL 130V	15S14/CL 130V	—
40S11N/1/F	40S11/N/CF 120V	40S11N/F 120V
40R14/N/CD	40R14/N/RP	40R14/N
40T6 1/2	40T6.5/CL	40T6-1/2 120V
40T8	40T8	40T8
40T10	40T10	40T10
60T10F/CD	60T10/CF	60T10/641F
<b>Incandescent Lamps (continued)</b>		
38A 130V	38A/CVP 130V	38A 120V
38A/CL 130V	not available in 130V	38A/CL 130V
40A15	40A15	40A15
40A 48PK	40A/CVP 130V	40A 130V
<b>Incandescent Lamps (continued)</b>		
50A19/RS/SH	50A/RS/SL	50A/RS/TF 120V
50/150	50/150A/W	50/150T/SW
<b>Incandescent Lamps (continued)</b>		
57A 130V	57A/CVP 130V	57A 130V
57A/CL 130V	57A/CL 130V	57A/CL 130V
60A15	60A15	60A15
60A 48PK	60A/CVP 130V	60A19/35
60A/RS 130V	60A/RS/2/RP 130V	—
60A/RS/STG	60A/RS/SL/RP 120V	—
60A/PL	60A/GRO	60A/AGRO
<b>Incandescent Lamps (continued)</b>		
65R30FL/LL	—	65BR30/FL/LL
65R30/SP/LL	—	65BR30/SP/LL
<b>Incandescent Lamps (continued)</b>		
71A 130V	71A/CVP 130V	71A 120V
71A/CL 130V	not available in 130V	71A/CL 130V
75A 48PK	75A/CVP 130V	75A
75A/RS/130	75A/RS/2/RP 130V	—
75A/RS/STG	75A21/RS/SL/RP 130V	75A/RH/TG 120-130V
<b>Incandescent Lamps (continued)</b>		
95A 130V	95A/CVP 130V	95A 120V
95A/CL 130V	not available in 130V	95A/CL 130V
100A 48PK	100A/CVP 130V	100A 130V
100A/RS 130V	100A/RS/2/RP 130V	—
100A/RS/STG	100A/RS/SL/RP 120V	100A/RS/VS/BR/TG 120-130V
100A23	100A23 12V	100A 12V
<b>Incandescent Lamps (continued)</b>		
150A21/RS	150A23/RS 130V	—
150A21/RS/STG	—	150A/35/RS/BR/TG 120-130V
150PS25/RS/STG	150PS25/RS/SL 120V	—
200PS30/RS/23/STG	200PS/RS/SL 120V	200PS30/RS/TF 120V
250R40/10	250R40/10	250R40/HR
300M	300M/CL	300-120V CLR PS30
300M/IF	300M/IF	300M/PS30IF 130V
15BC	15B10C/T	15BA9C
15FC	15FC	15F10C
<b>Incandescent Lamps (continued)</b>		
25BC	25B10C/T	25B10-1/2C
25BM	25B10	25B13
25CAC	25B10C	25BA9C/CL
25CAC/F	25B10C/W	25BA9C/F
25CAC/L	25B10C/DL	25BA9C/4M
25CAM	—	25BA9-1/2

GE Description Order This GE Lamp	Osram/Sylvania Description If you currently use these lamps	Philips Description If you currently use these lamps
<b>Incandescent Lamps (continued)</b>		
25FM/CF	—	—
25GC	25G16.5C	25G16-1/2C
25GM	25G16.5	25G16-1/2
25G25	25G25	25G25
<b>Incandescent Lamps (continued)</b>		
40BC	40B10C/T	40B10-1/2C
40BM	40B10	40B13
40CAC	40B10C	40BA9C/CL
40CAC/F	40B10C/F	40BA9C/F
40CAC/L	—	40BA9C/4M
40CAM	—	40BA9-1/2
40CAM/L	—	40BA9-1/2/LL
40FM/CF	—	—
40GC	40G16.5C	40G16-1/2C
40GM	40G16.5	40G16-1/2
40G25	40G25	40G25
<b>Incandescent Lamps (continued)</b>		
60BC	60B10C/T	60B10-1/2C
60BM	60B10	60B13
60CAC	60B10C	60BA9C/CL
60CAC/F	60B10C/F	60BA9C/F
60CAM	—	60BA9-1/2
60FM/CF	—	—
60GC	60G16.5C	60G16-1/2C
60GM	60G16.5	60G16-1/2
60G25	60G25	60G25

Incandescent  
Halogen  
High Intensity Discharge  
Fluorescent  
Compact Fluorescent  
Ballast  
LED Lamps and Systems  
Stage and Studio  
Miniature and Sealed Beam  
Projection

